

PARTS LIST										
ITEM	QTY	PART NO.	BOX NO.	PART DESCRIPTION	LENGTH	UNIT WT.	NET WT.			
1	6	X-251012		BALLAST TRAY WELDMENT - SITE PRO 1		36.58	219.48			
2	8	X-CSRT-P3096		2-7/8" DIA. PIPE X 96" LONG	96 in	48.99	391.96			
3	3	X-CSRT-3072FW		CSRT FLANGE PIPE WELDMENT 2-7/8" X 72"		39.16	117.47			
4	3	X-CSRT-3048FW		CSRT FLANGE PIPE WELDMENT 2-7/8" X 48"		26.85	80.54			
5	24	CSRT-PCB	P-CSRT-PCB	CSRT PIPE CLAMP BRACKET KIT		4.25	101.89			
6	12	CSRT-GP30	P-CSRT-GP30	CSRT GUSSET PLATE KIT		10.49	125.82			
7	1	CSRT-GP30D	P-CSRT-GP30D	CSRT DUAL GUSSET PLATE KIT		12.64	12.64			
8	12	G12045		1/2" x 4.5" HDG HEX BOLT GR5 FULL THREAD	4 1/2 in	0.30	3.58			
9	12	G1202		1/2" x 2" HDG HEX BOLT GR5	2 in	0.18	2.11			
10	12	G12LW		1/2" HDG LOCKWASHER	1/8 in	0.01	0.17			
11	12	G12NUT		1/2" HDG HEAVY 2H HEX NUT	7/8 in	0.07	0.86			
							<b>TOTAL WT. #</b>	<b>1068.66</b>		

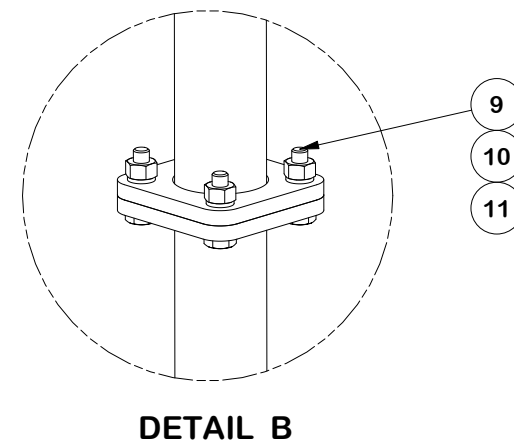
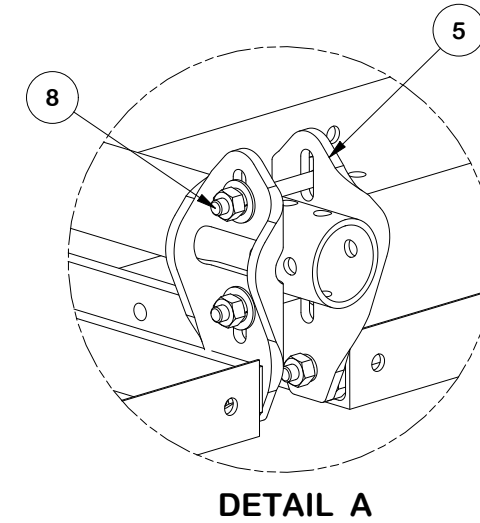
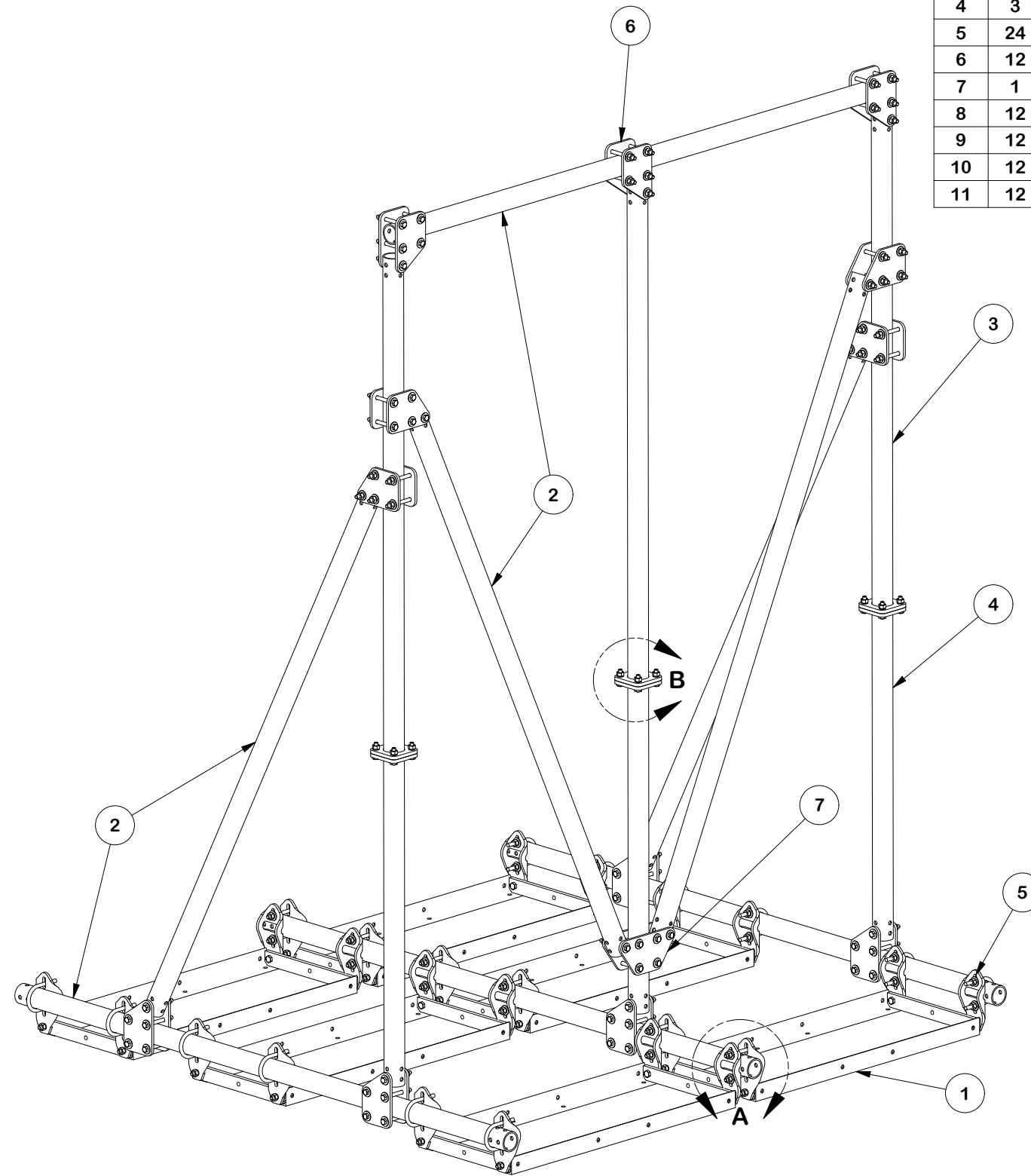

FINISH:  
HOT DIP GALVANIZED.

**TOLERANCE NOTES**

TOLERANCES ON DIMENSIONS, UNLESS OTHERWISE NOTED ARE:  
 SAWED, SHEARED AND GAS CUT EDGES ( $\pm 0.030"$ )  
 DRILLED AND GAS CUT HOLES ( $\pm 0.030"$ ) - NO CONING OF HOLES  
 LASER CUT EDGES AND HOLES ( $\pm 0.010"$ ) - NO CONING OF HOLES  
 BENDS AND ANGLES ARE  $\pm 1/2$  DEGREE  
 ALL OTHER MACHINING ( $\pm 0.030"$ )  
 ALL OTHER ASSEMBLY ( $\pm 0.060"$ )

PATENT INFORMATION: WWW.SITEPRO1.COM/PATENTS

PROPRIETARY NOTE:  
 THE DATA AND TECHNIQUES CONTAINED IN THIS DRAWING ARE PROPRIETARY INFORMATION OF VALMONT INDUSTRIES AND CONSIDERED A TRADE SECRET. ANY USE OR DISCLOSURE WITHOUT THE CONSENT OF VALMONT INDUSTRIES IS STRICTLY PROHIBITED.

DESCRIPTION  
**CSRT SERIES™ 3 PIPE SLOPE MOUNT**  
**8' FACE X 10' MAST X 8' DEPTH**

CPD NO.	DRAWN BY	ENG. APPROVAL
SP1	SDR 10/6/2025	11/11/2025
CLASS	DRAWING USAGE	CHECKED BY
87	CUSTOMER	ADB 11/11/2025



Engineering Support Team:  
 sp1engineering@valmont.com

PART NO.	CSRT3-8108
DWG. NO.	CSRT3-8108

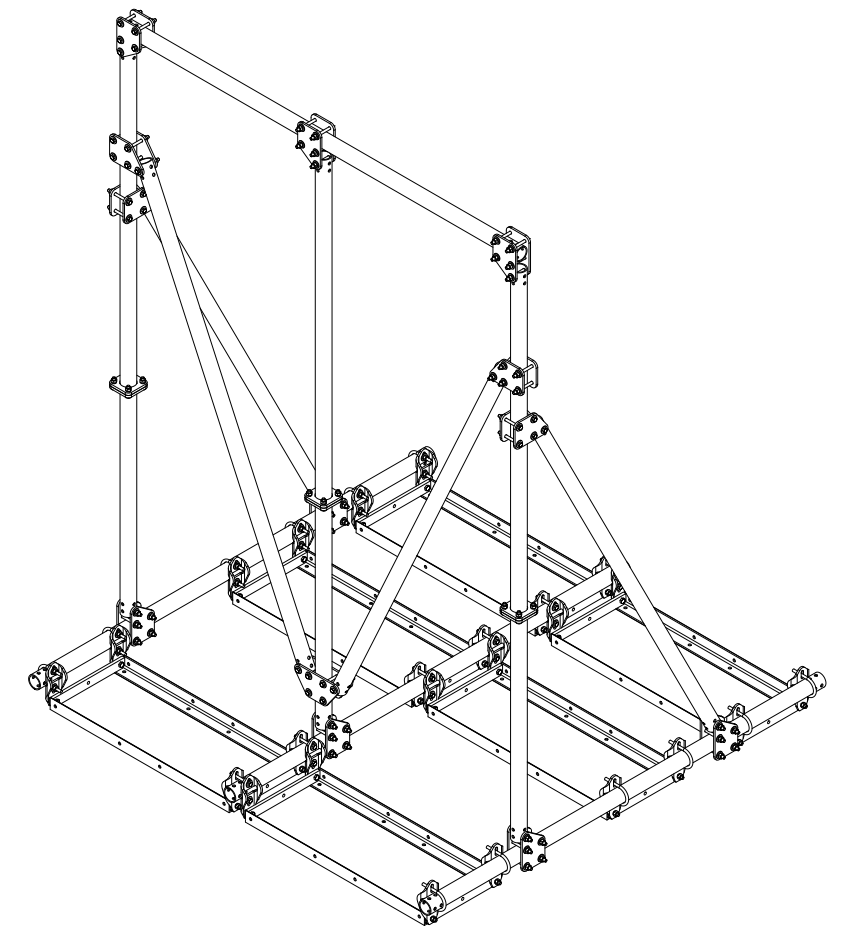
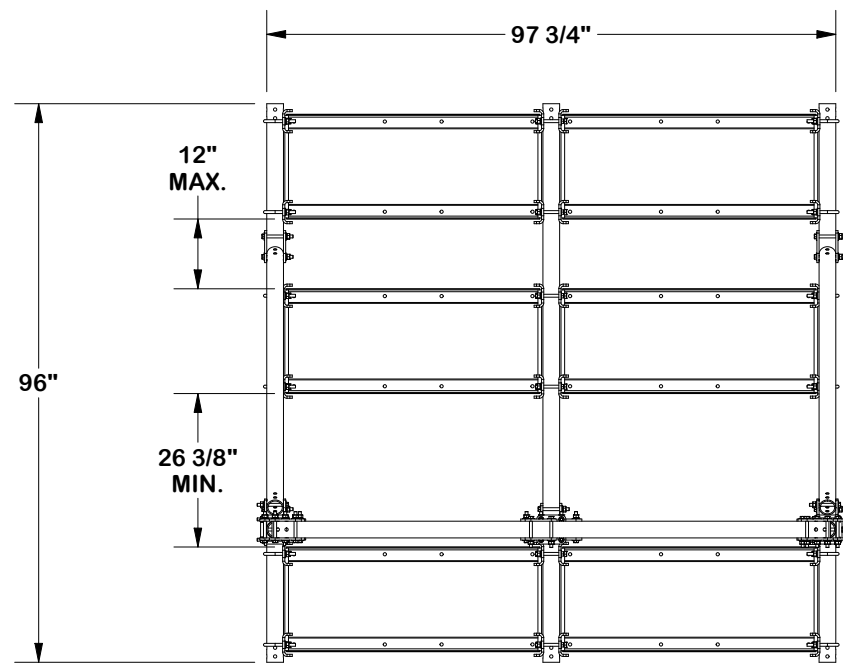

PIPE CENTER TO CENTER SPACING

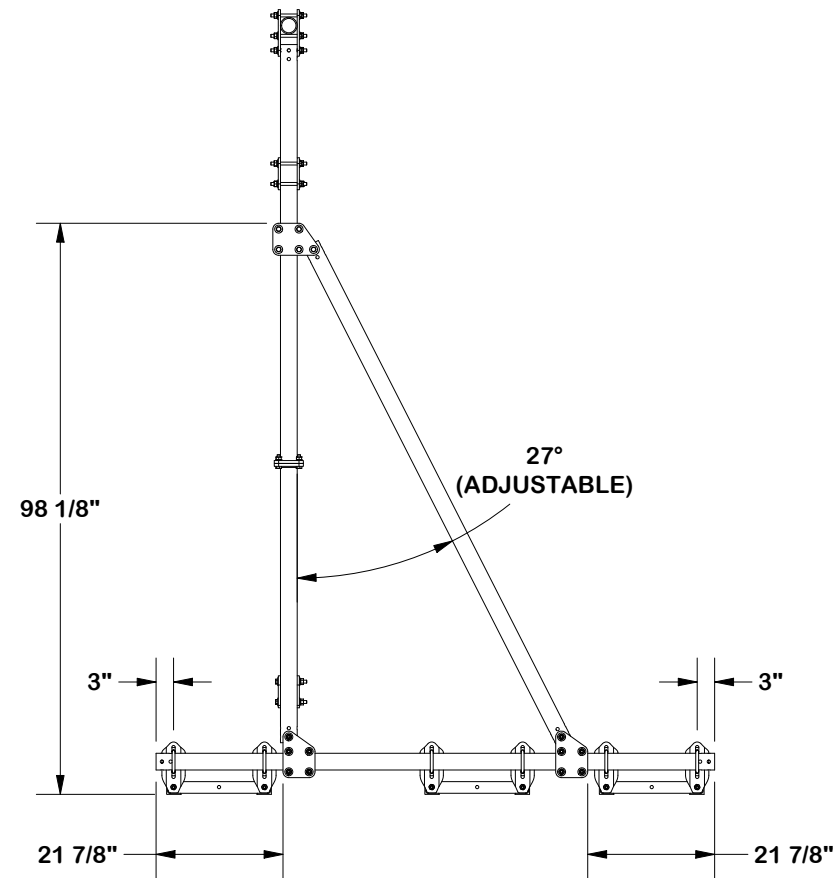
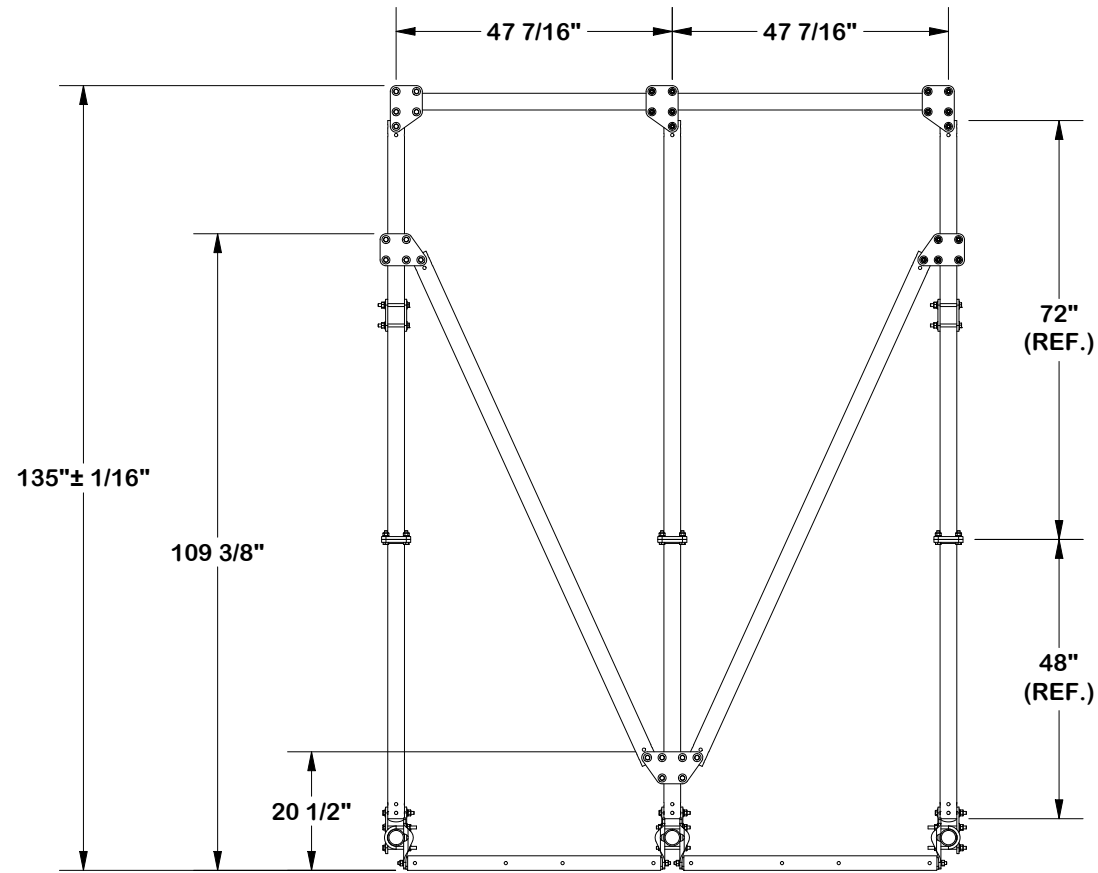

**TOLERANCE NOTES**

TOLERANCES ON DIMENSIONS, UNLESS OTHERWISE NOTED ARE:  
 SAWED, SHEARED AND GAS CUT EDGES ( $\pm 0.030"$ )  
 DRILLED AND GAS CUT HOLES ( $\pm 0.030"$ ) - NO CONING OF HOLES  
 LASER CUT EDGES AND HOLES ( $\pm 0.010"$ ) - NO CONING OF HOLES  
 BENDS AND ANGLES ARE  $\pm 1/2$  DEGREE  
 ALL OTHER MACHINING ( $\pm 0.030"$ )  
 ALL OTHER ASSEMBLY ( $\pm 0.060"$ )

PATENT INFORMATION: WWW.SITEPRO1.COM/PATENTS

PROPRIETARY NOTE:  
 THE DATA AND TECHNIQUES CONTAINED IN THIS DRAWING ARE PROPRIETARY INFORMATION OF VALMONT INDUSTRIES AND CONSIDERED A TRADE SECRET. ANY USE OR DISCLOSURE WITHOUT THE CONSENT OF VALMONT INDUSTRIES IS STRICTLY PROHIBITED.

DESCRIPTION  
**CSRT SERIES™ 3 PIPE SLOPE MOUNT**  
**8' FACE X 10' MAST X 8' DEPTH**

CPD NO. <b>SP1</b>	DRAWN BY <b>SDR 10/6/2025</b>	ENG. APPROVAL <b>11/11/2025</b>
CLASS <b>87</b>	SUB <b>02</b>	DRAWING USAGE <b>CUSTOMER</b>
CHECKED BY <b>ADB 11/11/2025</b>		

**SITE PRO 1**  
 A valmont COMPANY

Engineering Support Team:  
 sp1engineering@valmont.com

PART NO. <b>CSRT3-8108</b>
DWG. NO. <b>CSRT3-8108</b>

# CSRT™ SLOPE REFERENCE

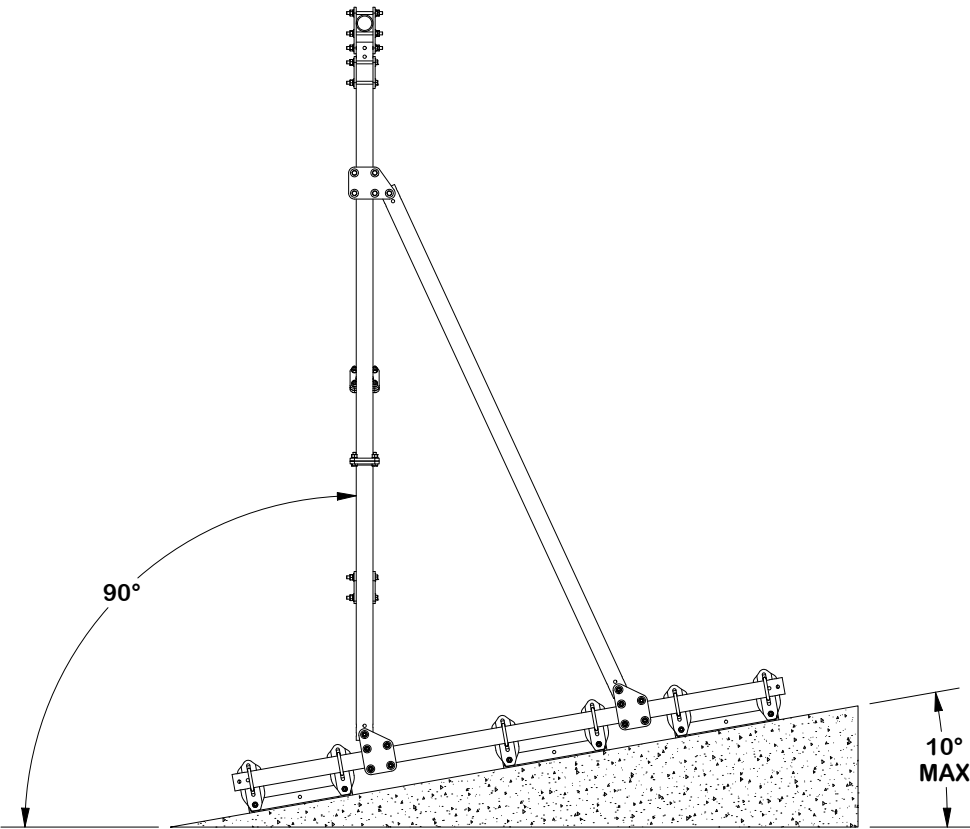

**RIGHT SIDE VIEW  
FRONT SLOPE**

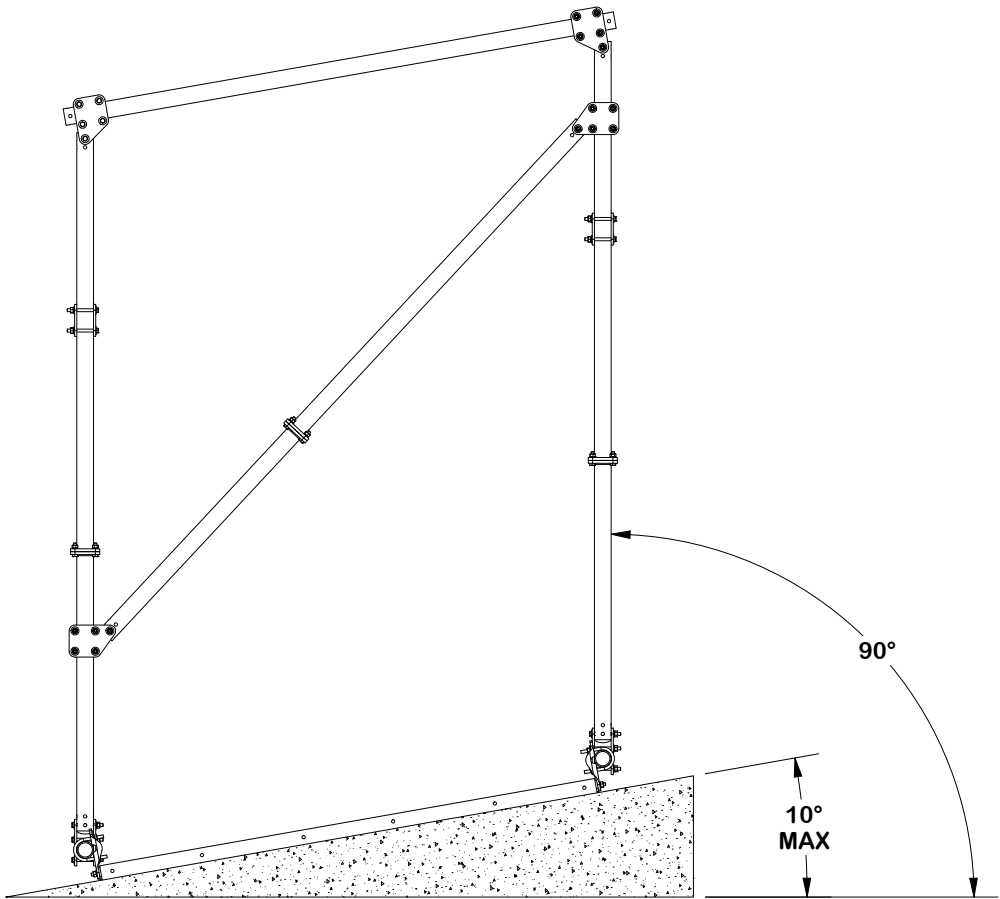

**FRONT VIEW  
SIDE SLOPE**

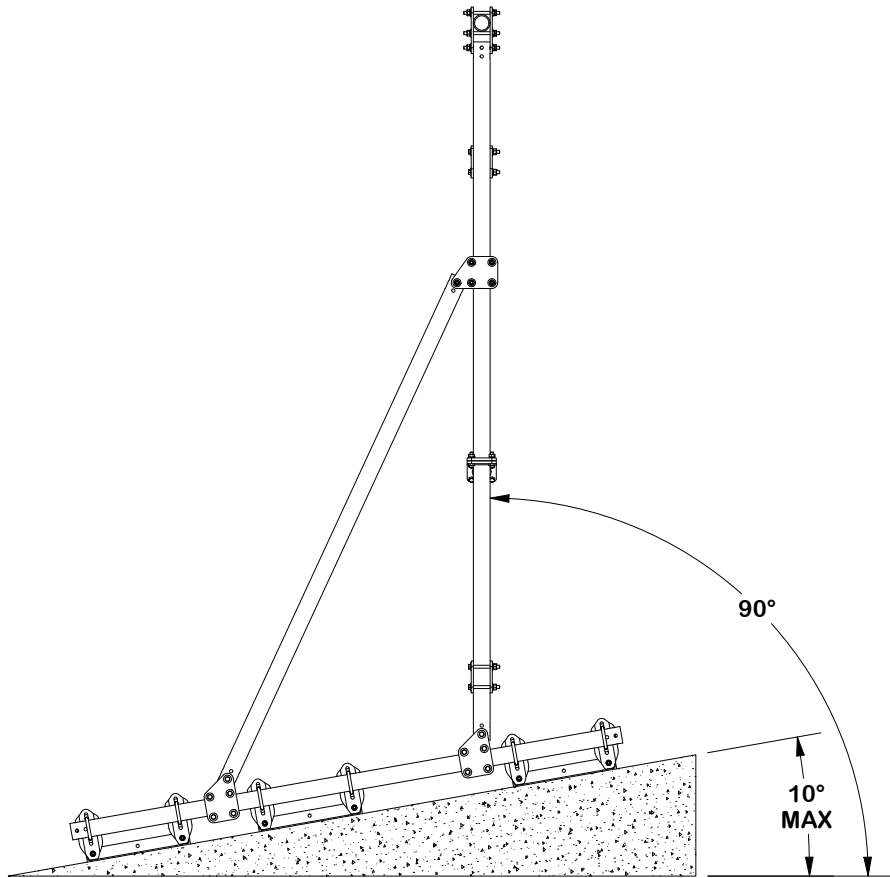

**LEFT SIDE VIEW  
BACK SLOPE**

**TOLERANCE NOTES**

TOLERANCES ON DIMENSIONS, UNLESS OTHERWISE NOTED ARE:  
 SAWED, SHEARED AND GAS CUT EDGES ( $\pm 0.030"$ )  
 DRILLED AND GAS CUT HOLES ( $\pm 0.030"$ ) - NO CONING OF HOLES  
 LASER CUT EDGES AND HOLES ( $\pm 0.010"$ ) - NO CONING OF HOLES  
 BENDS AND ANGLES ARE  $\pm 1/2$  DEGREE  
 ALL OTHER MACHINING ( $\pm 0.030"$ )  
 ALL OTHER ASSEMBLY ( $\pm 0.060"$ )

PATENT INFORMATION: WWW.SITEPRO1.COM/PATENTS

PROPRIETARY NOTE:  
 THE DATA AND TECHNIQUES CONTAINED IN THIS DRAWING ARE PROPRIETARY INFORMATION OF VALMONT INDUSTRIES AND CONSIDERED A TRADE SECRET. ANY USE OR DISCLOSURE WITHOUT THE CONSENT OF VALMONT INDUSTRIES IS STRICTLY PROHIBITED.

DESCRIPTION  
**CSRT SERIES™ 3 PIPE SLOPE MOUNT  
 8' FACE X 10' MAST X 8' DEPTH**

CPD NO. <b>SP1</b>	DRAWN BY <b>SDR 10/6/2025</b>	ENG. APPROVAL <b>11/11/2025</b>
CLASS <b>87</b>	SUB <b>02</b>	DRAWING USAGE <b>CUSTOMER</b>
		CHECKED BY <b>ADB 11/11/2025</b>



Engineering Support Team:  
 sp1engineering@valmont.com

PART NO. <b>CSRT™ SLOPE REF</b>
DWG. NO. <b>CSRT3-8108</b>

PARTS LIST						
ITEM	QTY	PART NO.	PART DESCRIPTION	LENGTH	UNIT WT.	NET WT.
1	1	X-CSRT-PCB	PIPE CONNECTION BRACKET	12 in	3.01	3.01
2	1	X-UB1300	1/2" X 3" X 5" X 2" GALV U-BOLT		0.74	0.74
3	1	G1202	1/2" x 2" HDG HEX BOLT GR5	2 in	0.18	0.18
4	2	G12FW	1/2" HDG USS FLATWASHER	3/32 in	0.03	0.07
5	3	G12LW	1/2" HDG LOCKWASHER	1/8 in	0.01	0.04
6	3	G12NUT	1/2" HDG HEAVY 2H HEX NUT	7/8 in	0.07	0.21
					TOTAL WT. #	4.25

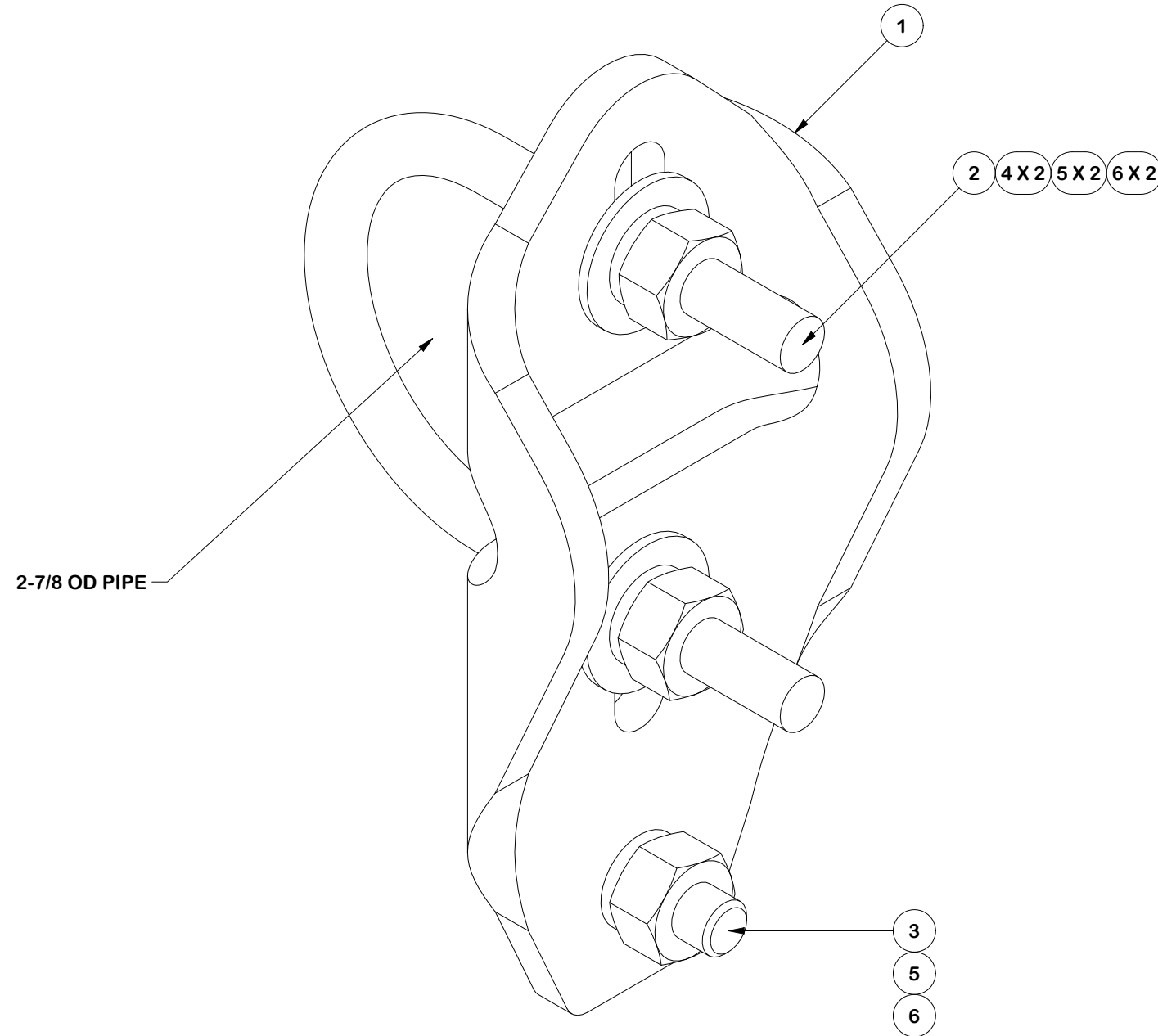

FINISH:  
HOT DIP GALVANIZED.

**TOLERANCE NOTES**

TOLERANCES ON DIMENSIONS, UNLESS OTHERWISE NOTED ARE:  
 SAWED, SHEARED AND GAS CUT EDGES ( $\pm 0.030"$ )  
 DRILLED AND GAS CUT HOLES ( $\pm 0.030"$ ) - NO CONING OF HOLES  
 LASER CUT EDGES AND HOLES ( $\pm 0.010"$ ) - NO CONING OF HOLES  
 BENDS AND ANGLES ARE  $\pm 1/2$  DEGREE  
 ALL OTHER MACHINING ( $\pm 0.030"$ )  
 ALL OTHER ASSEMBLY ( $\pm 0.060"$ )

PATENT INFORMATION: WWW.SITEPRO1.COM/PATENTS

PROPRIETARY NOTE:  
 THE DATA AND TECHNIQUES CONTAINED IN THIS DRAWING ARE PROPRIETARY INFORMATION OF VALMONT INDUSTRIES AND CONSIDERED A TRADE SECRET. ANY USE OR DISCLOSURE WITHOUT THE CONSENT OF VALMONT INDUSTRIES IS STRICTLY PROHIBITED.

DESCRIPTION  
**CSRT SERIES™ 3 PIPE SLOPE MOUNT  
 8' FACE X 10' MAST X 8' DEPTH**

**SITE PRO 1**  
 A valmont COMPANY  
 Engineering Support Team:  
 sp1engineering@valmont.com

CPD NO. <b>SP1</b>	DRAWN BY <b>SDR 10/6/2025</b>	ENG. APPROVAL <b>11/11/2025</b>
CLASS <b>87</b>	SUB <b>02</b>	DRAWING USAGE <b>CUSTOMER</b>
CHECKED BY <b>ADB 11/11/2025</b>		

PART NO. <b>CSRT-PCB</b>	PAGE 4 OF 6
DWG. NO. <b>CSRT3-8108</b>	

PARTS LIST						
ITEM	QTY	PART NO.	PART DESCRIPTION	LENGTH	UNIT WT.	NET WT.
1	2	X-CSRT-GP30	3" GUSSET PLATE	12 in	4.04	8.09
2	5	G1205	1/2" x 5" HDG HEX BOLT GR5 FULL THREAD	5 in	0.33	1.63
3	10	G12FW	1/2" HDG USS FLATWASHER	3/32 in	0.03	0.34
4	5	G12LW	1/2" HDG LOCKWASHER	1/8 in	0.01	0.07
5	5	G12NUT	1/2" HDG HEAVY 2H HEX NUT	7/8 in	0.07	0.36
					TOTAL WT. #	10.49

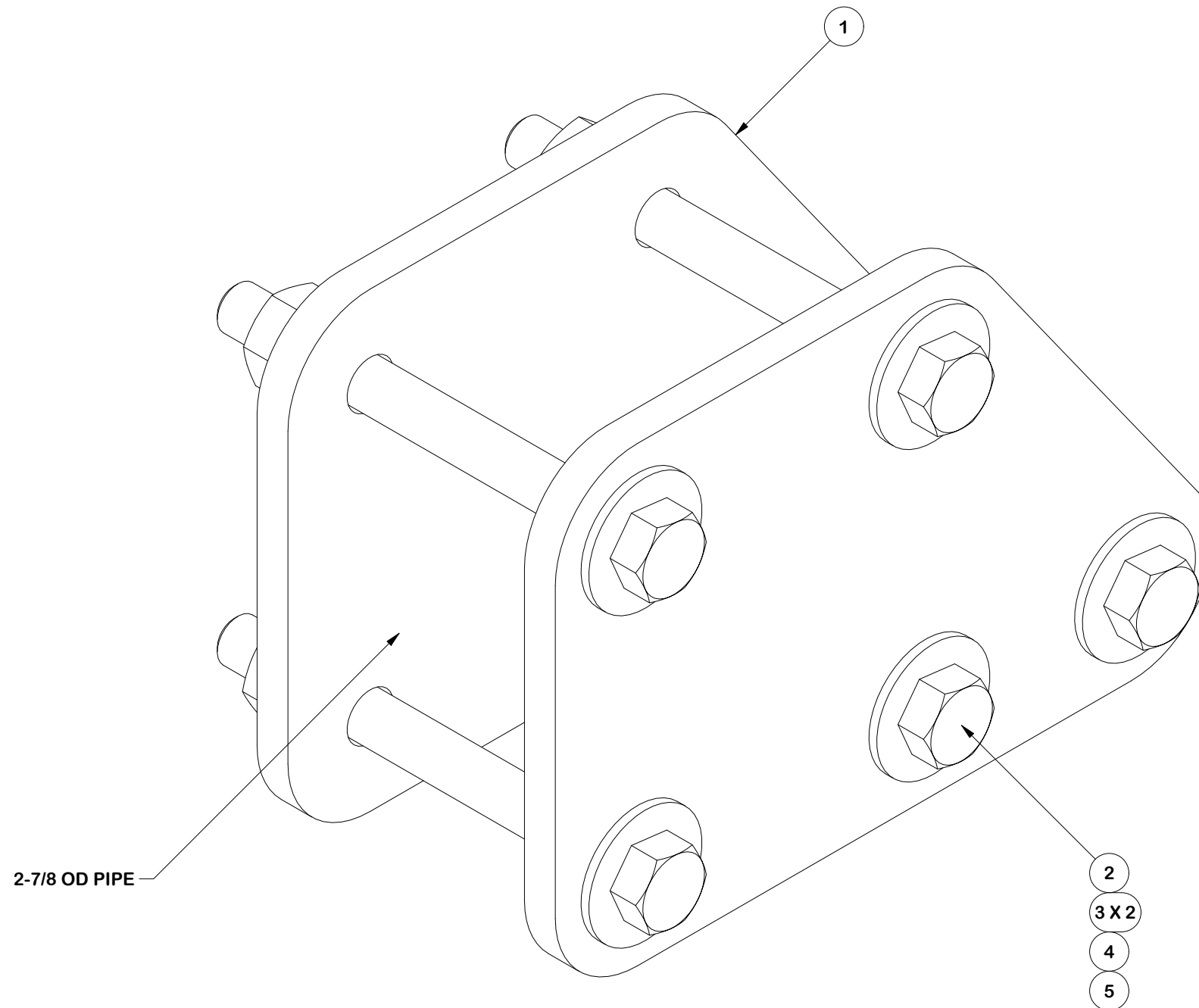

**FINISH:**  
HOT DIP GALVANIZED.

**TOLERANCE NOTES**

TOLERANCES ON DIMENSIONS, UNLESS OTHERWISE NOTED ARE:  
 SAWED, SHEARED AND GAS CUT EDGES ( $\pm 0.030"$ )  
 DRILLED AND GAS CUT HOLES ( $\pm 0.030"$ ) - NO CONING OF HOLES  
 LASER CUT EDGES AND HOLES ( $\pm 0.010"$ ) - NO CONING OF HOLES  
 BENDS AND ANGLES ARE  $\pm 1/2$  DEGREE  
 ALL OTHER MACHINING ( $\pm 0.030"$ )  
 ALL OTHER ASSEMBLY ( $\pm 0.060"$ )

PATENT INFORMATION: WWW.SITEPRO1.COM/PATENTS

PROPRIETARY NOTE:  
 THE DATA AND TECHNIQUES CONTAINED IN THIS DRAWING ARE PROPRIETARY INFORMATION OF VALMONT INDUSTRIES AND CONSIDERED A TRADE SECRET. ANY USE OR DISCLOSURE WITHOUT THE CONSENT OF VALMONT INDUSTRIES IS STRICTLY PROHIBITED.

DESCRIPTION  
**CSRT SERIES™ 3 PIPE SLOPE MOUNT  
 8' FACE X 10' MAST X 8' DEPTH**

CPD NO. <b>SP1</b>	DRAWN BY <b>SDR 10/6/2025</b>	ENG. APPROVAL <b>11/11/2025</b>
CLASS <b>87</b>	SUB <b>02</b>	DRAWING USAGE <b>CUSTOMER</b>
CHECKED BY <b>ADB 11/11/2025</b>		

**SITE PRO 1**  
 A valmont COMPANY

Engineering Support Team:  
 sp1engineering@valmont.com

PART NO. <b>CSRT-GP30</b>	PAGE 5 OF 6
DWG. NO. <b>CSRT3-8108</b>	

PARTS LIST						
ITEM	QTY	PART NO.	PART DESCRIPTION	LENGTH	UNIT WT.	NET WT.
1	2	X-CSRT-GP30D	3" DOUBLE GUSSET PLATE	24 in	4.88	9.76
2	6	G1205	1/2" x 5" HDG HEX BOLT GR5 FULL THREAD	5 in	0.33	1.96
3	12	G12FW	1/2" HDG USS FLATWASHER	3/32 in	0.03	0.41
4	6	G12LW	1/2" HDG LOCKWASHER	1/8 in	0.01	0.08
5	6	G12NUT	1/2" HDG HEAVY 2H HEX NUT	7/8 in	0.07	0.43
					TOTAL WT. #	12.64

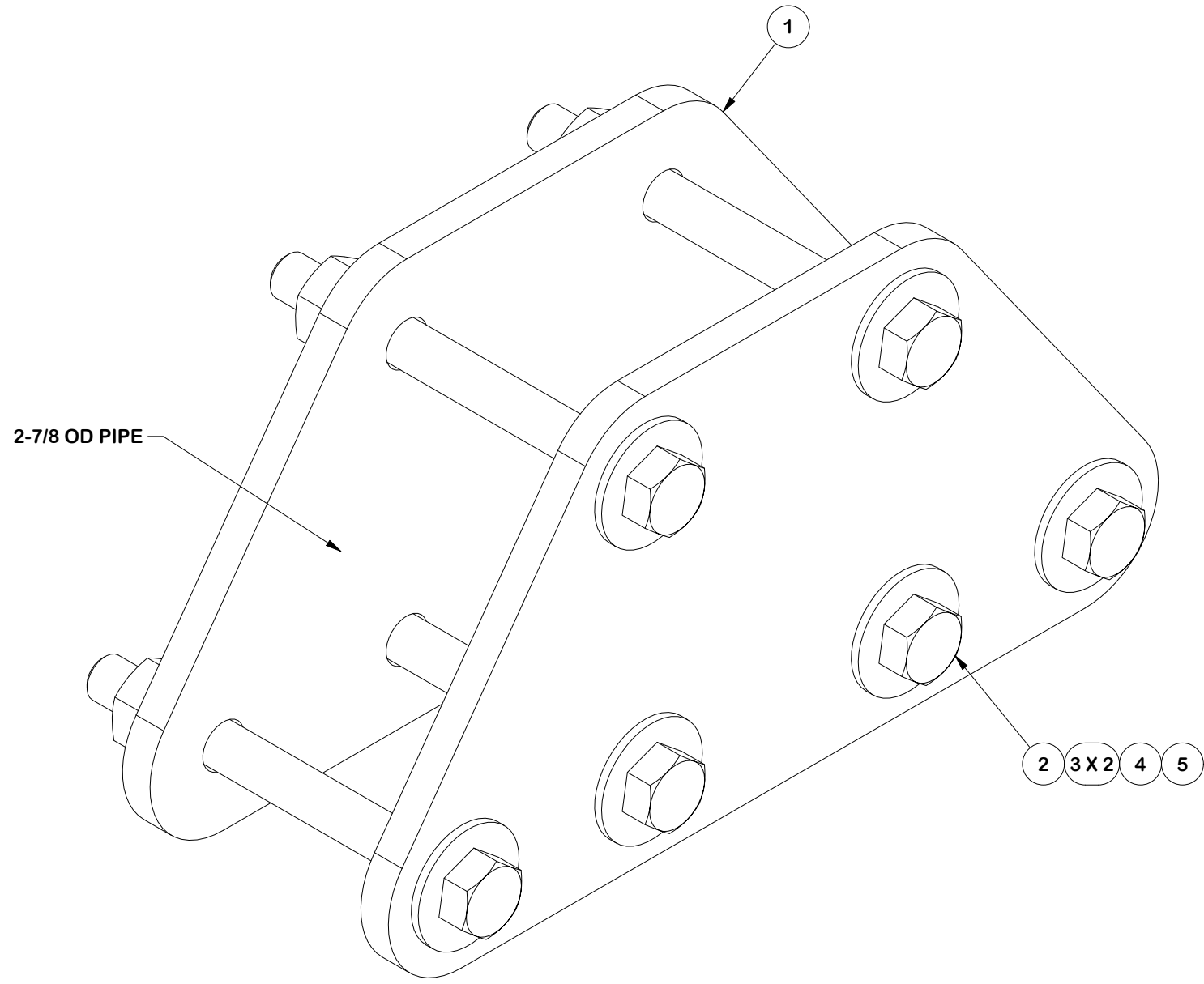

FINISH:  
HOT DIP GALVANIZED.

**TOLERANCE NOTES**

TOLERANCES ON DIMENSIONS, UNLESS OTHERWISE NOTED ARE:  
 SAWED, SHEARED AND GAS CUT EDGES ( $\pm 0.030"$ )  
 DRILLED AND GAS CUT HOLES ( $\pm 0.030"$ ) - NO CONING OF HOLES  
 LASER CUT EDGES AND HOLES ( $\pm 0.010"$ ) - NO CONING OF HOLES  
 BENDS AND ANGLES ARE  $\pm 1/2$  DEGREE  
 ALL OTHER MACHINING ( $\pm 0.030"$ )  
 ALL OTHER ASSEMBLY ( $\pm 0.060"$ )

PATENT INFORMATION: WWW.SITEPRO1.COM/PATENTS

PROPRIETARY NOTE:  
 THE DATA AND TECHNIQUES CONTAINED IN THIS DRAWING ARE PROPRIETARY INFORMATION OF VALMONT INDUSTRIES AND CONSIDERED A TRADE SECRET. ANY USE OR DISCLOSURE WITHOUT THE CONSENT OF VALMONT INDUSTRIES IS STRICTLY PROHIBITED.

DESCRIPTION  
**CSRT SERIES™ 3 PIPE SLOPE MOUNT**  
**8' FACE X 10' MAST X 8' DEPTH**



Engineering Support Team:  
 sp1engineering@valmont.com

CPD NO.	DRAWN BY	ENG. APPROVAL
SP1	SDR 10/6/2025	11/11/2025
CLASS	DRAWING USAGE	CHECKED BY
87	CUSTOMER	ADB 11/11/2025

PART NO.	CSRT-GP30D
DWG. NO.	CSRT3-8108